

STANDARD FEATURES

1. *Powerclaw* latching system
2. Removable protective web
3. Smart strap
4. Molded seal
5. Pressure equalizer valve
6. Polycarbonate shell
7. Impact bumpers
8. Belt loops
9. Caribiner loop
10. Rubberized interior
11. Removable *Velcro* hand strap



Waterproof Case Operation Manual

Use with
Ranger
Monitor 200
Monitor 1000EC



SPECIFICATIONS

| | |
|------------------------|--|
| Interior Dimensions | 6.7" x 3.8" x 7.9" 170mm x 96mm x 49 mm |
| Exterior Dimensions | 7.4" x 5.1" x 2.6" 188mm x 130mm x 65mm |
| Weight (empty) | 1.1lb .5 kg |
| Lit Depth | 0.5" 13mm |
| Base Depth | 1.4" 36mm |
| Max Buoyancy | 1.7lb 0.8kg |
| Temperature Range | min -20°F (-29°C) max 140°F (60°C) |
| Airline Cabin Carry-on | YES |
| Watertight | YES *(not for use diving) |
| Warranty | Conditional lifetime guarantee from manufacturer |



IPX5 INGRESS PROTECTION -
WATERPROOF



IP6X INGRESS PROTECTION -
DUST PROOF

MATERIALS

| | |
|---------------|---------------------|
| Case Sell | Polycarbonate +ABS |
| Bumpers | TPE |
| Pins/Hardware | 304 Stainless Steel |
| Purge Valve | Nylon Gore membrane |
| Strap | Nylon POM |
| Interior Web | TPE |

Push down on the black button. Pull out bottom latch, then flip open top latch.

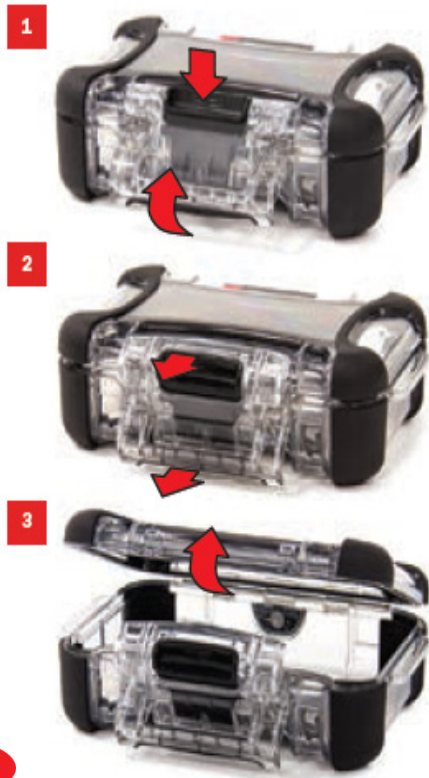

Step 1.

For full view of the monotor screen, the front webbing must be removed.

Remove the 2 screws and bushings and set them aside - instuments fit best in case without these items. Detach the web from the hooks.

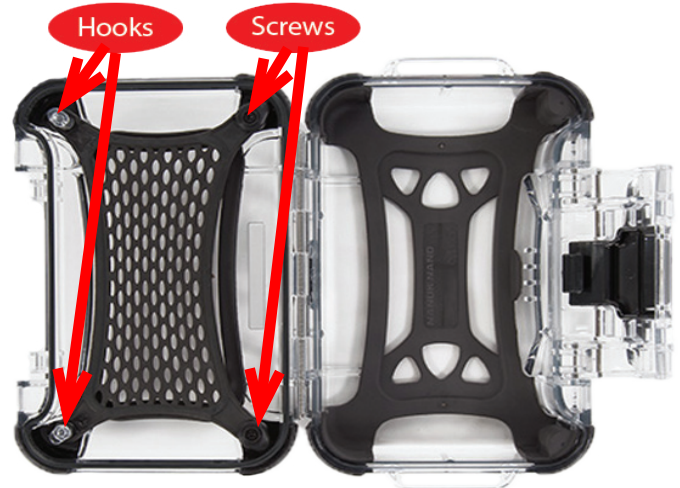

Step 2.

Place the webbing in the bottom of the case.



Step 3.

Insert your instrument in rubber boot face up in the bottom half. Close lid and secure latch.



Step 4.